

# Physical Site Assessment

Final Report



## Site:

Hamilton Public Library- *Terryberry Branch*

Website: <https://www.hpl.ca/terryberry>

## Address:

100 Mohawk Rd W,  
Hamilton, ON, L9C 1W1

## Provided by:

Hamoon Zamani Moghadam

# Table of Contents

Introduction.....	3
Procedure.....	3
Asset Valuation.....	4
First Floor.....	5
Sketch .....	5
Points of Interest .....	6
First Floor Photos.....	11
Second Floor .....	23
Sketch .....	23
Points of Interest.....	24
Second Floor Photos.....	28
Wi-Fi & SSID .....	33
Staff Security Practice.....	33
Recommendations.....	34
Conclusion .....	34

## Introduction

The Hamilton Public Library is a community institution that plays a critical role in providing educational and informational resources to the public. The library serves as a hub of knowledge and learning, providing access to a vast collection of books, magazines, DVDs, CDs, and other materials. Additionally, the library also offers access to computers, printers, scanners, and 3D printers, making it a vital resource for students, researchers, and members of the community.

The library's collection of materials includes not only contemporary books and media, but also historic and unique materials that hold significant cultural and educational value. The library's collection is a valuable asset, and it is essential that it is protected from damage, loss, or theft. Furthermore, the library's technology resources, including computers, printers, and scanners, are also valuable assets that must be secured against potential threats. This report will focus on the physical security of the Hamilton Public Library, with the aim of evaluating the current security measures in place and making recommendations for enhancing security and mitigating risks.

## Procedure

The purpose of this assessment was to evaluate the existing security controls in place and identify any potential vulnerabilities that could be exploited by an attacker. The first step in the process was to obtain permission from the library administration to conduct the assessment. Once permission was obtained, the assessment began with a thorough examination of the library's physical security measures, which included taking photographs of various security controls, such as cameras, LPS, motion detectors, doors, locks etc. As part of the assessment, an asset valuation was made, and the library staff were interviewed to gather additional information about their security practices and procedures. The assessment was conducted to identify any vulnerabilities that may exist in the library's physical security measures, and to provide recommendations to improve security and reduce potential risks. The information obtained through the assessment is used to develop a report aimed at enhancing the library's physical security measures and reducing the likelihood of security breaches.

## Asset Valuation

ASSETS	Value
Members' personal information (name, address, library Id)	Quantitative Asset
Staff and employee's personal information	Quantitative Asset
Books	<i>\$50,000 - \$70,000</i>
Paper and 3D printers	<i>\$10,000 - \$16,000</i>
Plotter printer	\$4,000 - \$6,000
Scanners	\$5,000 - \$8,000
Computers	<i>\$7,000 - \$12,000</i>
Digital Media	\$7,000 - \$10,000

# First Floor

Sketch

## WEST 5TH STREET

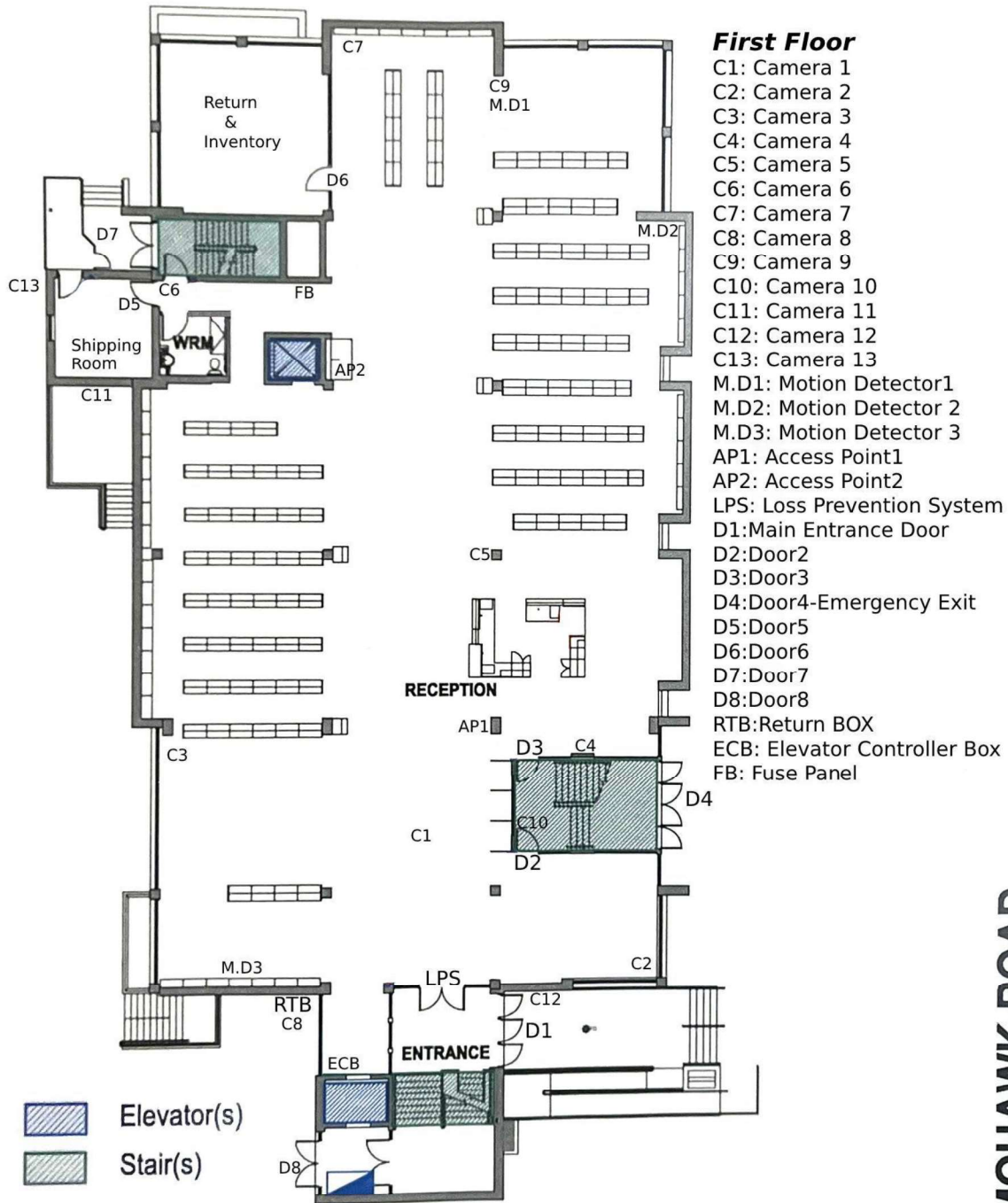

## Security Controls Description

---

### Cameras:

C1 to C13

**Security control type:** Detect and Deter

Deter and detect casual and motivated attackers. Determined attackers are still a threat.

Seeing a camera can cause an attacker to think twice about attempting to break in.

#### Strengths:

- Strategically placed and cover all critical areas of the facility.
- Not physically reachable by attackers

#### Weakness:

- Not monitored locally
- In case of power outage, the cameras stop working.

**Risk level:** high

#### Recommendations:

- Purchase UPS and ensure the cameras stay on in case of power outage.
- Have a big screen in the library to monitor the cameras locally.

**Cost to mitigate risk:** high

---

### Motion Detectors:

M.D1-2-3

**Security control type:** Detect and Deter

This control can stop casual and motivated attackers.

#### Strengths:

- Easy to install and configure.

- Connected to alarm systems and can trigger the alarm.

**Weakness:**

- Motion detectors do not cover all the critical areas and there are some blind spots.
- False alarm

**Risk level: high**

**Recommendations:**

- Add more detectors and make sure to have full coverage.
- Tune the sensitivity level to avoid false alarm

**Cost to mitigate risk: medium**

---

**Access Points:**

A.P1: Access Point brand: Aruba

This AP is not physically reachable by casual attackers to plug or unplug cables. More details on wireless in the last section of the report.

A.P2: Access Point brand: HP

This one is behind a computer on a desk, and everyone can have physical access to it.

**Strengths:**

- Network segmentation (AP1) [Guest network – Staff network]
- Only Guest network is wireless.
- Not physically reachable therefore no one can use the LAN ports (AP1)
- Does not provide a wireless access (AP2)

**Weakness:**

- Physically reachable so an attacker can take advantage of LAN ports (AP2)

**Risk level: high**

**Recommendations:**

- Disable LAN ports on AP2.